



All the patents are held accountable counterfeiting.

Features



Green Power

- Standard/Din Rail Mounting Dual Purpose, meet EU EN 43880 installation dimension standard 2SU
- Width only 35mm(2SU)
- -20~+70°C wide working temperature, optional -40 °C
- No minimum load required
- DC output adjustable(±10%)
- Cooling by free air convection
- Can be installed on din rail TS-35/7.5 or 15
- Protections: Short circuit / Overload / Over voltage
- 3KVac I/O isolation
- 3 years warranty



DIMENSIONS:52.5(H)*90.7(D)*35(W)mm

WEIGHTS: 117g

Detail specifications

MODEL DAD1030D		24I-05	24I-12	24I-15	24I-24
OUTPUT	DC voltage	5V	12V	15V	24V
	Rated Current	6A	2.5A	2A	1.25A
	Current Range	0~6A	0~2.5A	0~2A	0~1.25A
	Rated Power	30W	30W	30W	30W
	Ripple&Noise(max.)	60mVp-p	75mVp-p	75mVp-p	100mVp-p
	Voltage Adj. Range	4.5~5.5V	10.8~13.2V	13.5~16.5V	21.6~26.4V
	Voltage Tolerance	±2.0%	±2.0%	±2.0%	±2.0%
	Line Regulation	±0.5%	±0.5%	±0.5%	±0.5%
	Load Regulation	±1.5%	±0.5%	±0.5%	±0.5%
	Setup, Rise Time	120ms, 85ms at full load.			
	Hold Up Time(Typ.)	5ms@24Vac input			
	External Capacitance load(Max.)	3300µF	2200µF	1500µF	1000µF
INPUT	Voltage Range	19.2~32Vac			
	Efficiency(Typ.)	82%	83%	84%	86.5%
	AC Current(Typ.)	1.5A/24Vac			
	Inrush Current(Typ.)	15A/24Vac			
PROTECTION	Overload	105~135% rated output power.			
	Over Voltage	6~7.5V	14~17V	20.9~23.1V	28~34V



All the patents are held accountable counterfeiting.

CE Standards

EN 55032, EN 61000-3-3, (EN 61000-4-2, EN 61000-4-3, EN 61000-4-4, EN 61000-4-5, EN 61000-4-6, EN 61000-4-8), IEC 62368-1(LVD), Heavy Industry level, criteria A

Safety Standards

UL 508 Design Reference
CE Marking

Environments

Operating Temperature -20 ~ 70°C, Ambient
Operating Humidity 20 ~ 90% RH, No Condensing
Storage Temperature -20 ~ 85°C, Ambient
Vibration 2G, 10~500Hz, 3 axes

NOTE

- 1. Each output can provide up to maximum load, but total load can not exceed rated output power.
2. Line regulation is measured from low line to high line at rated load.
3. Load regulation is measured from 20% to 100% of rated load at 24VAC input.
4. Ripple & Noise are measured with 20MHz oscilloscope at 24VAC by using a 20cm long 12" twisted pair-wire with a 0.1uF/630V metal capacitor & a 47uF electrolytic capacitor parallel on the test point.
5. Efficiency is measured at rated load and 24VAC input.
6. Hold-up time is measured at rated load and 24VAC input.
7. Output Voltage Adjustable is measured on 5% of rated load.
8. When placing an order, model name is composed of "series name" and "model name on top of the specification form". For example, model name of 24I-05 of the order on top of the specification form is DAD1030D24I-05.
9. Reign Power reserve the right to change specifications at any time without notice.

Derating Curve

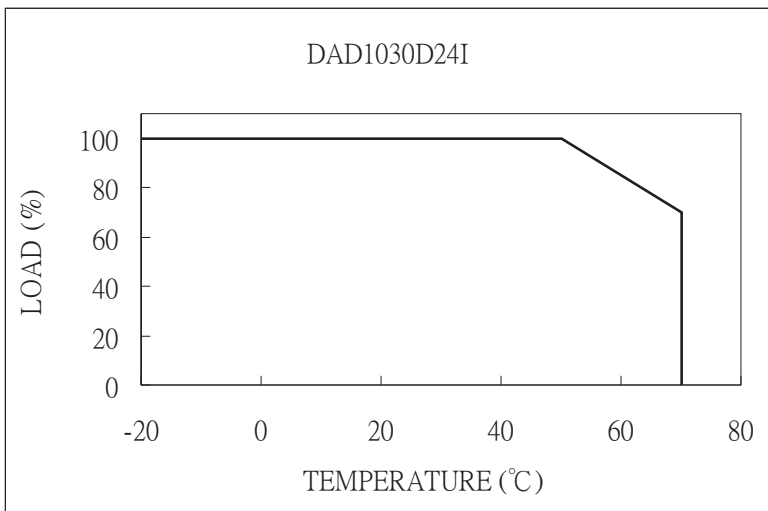



All the patents are held accountable counterfeiting.

Mechanical Details

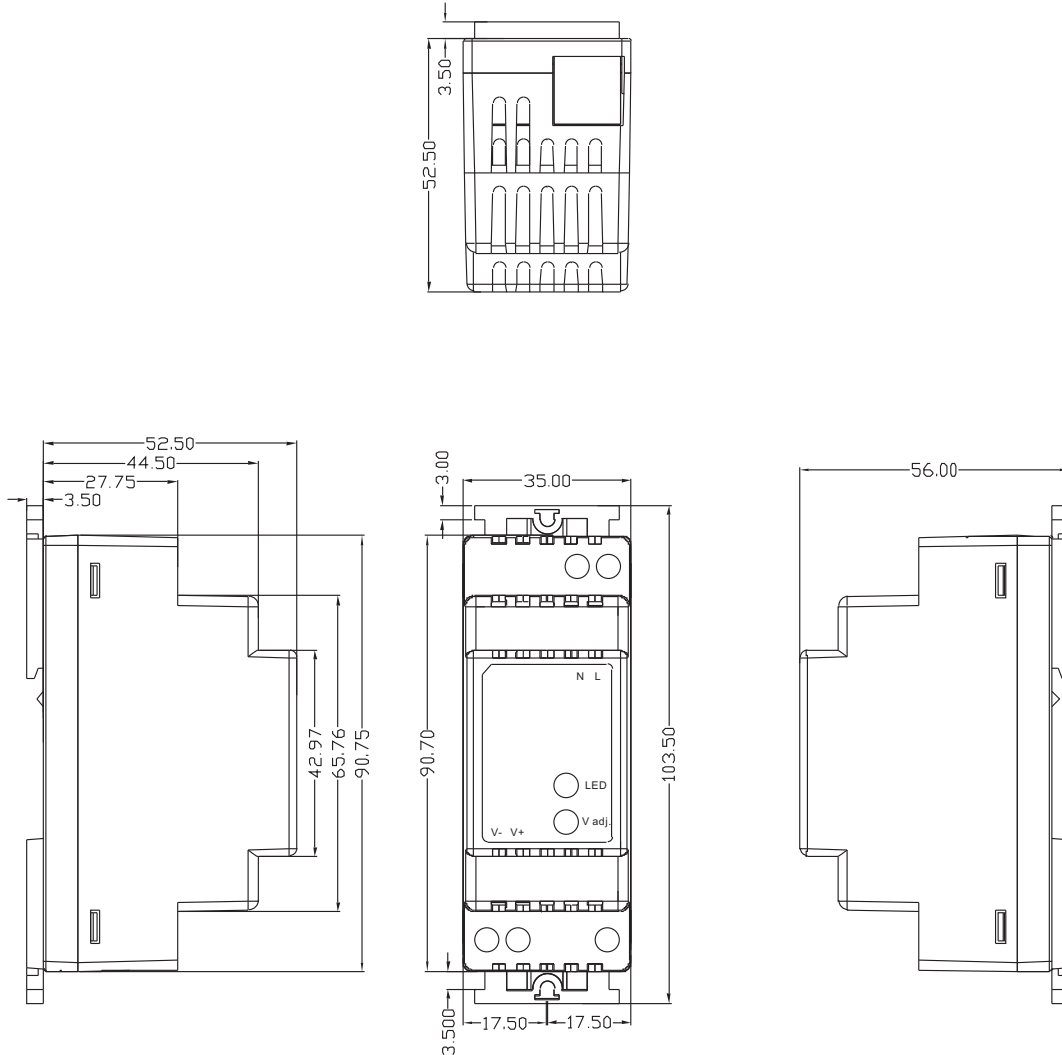

Panel Designation

CASE NO. : CS025D
UNIT : mm
DIMENSION : 52.5(H)*90.7(D)*35(W)
MATERIAL : PLASTIC
COLOR : BLACK

Symbol	Description
N	Neutral Terminal Of AC Input (No Polarity At DC Input)
L	Line Terminal Of AC Input (No Polarity At DC Input)
V-	DC Negative Output Terminal
V+	DC Positive Output Terminal
LED	Green LED Indicator
V adj.	Potentiometer For Output Voltage